

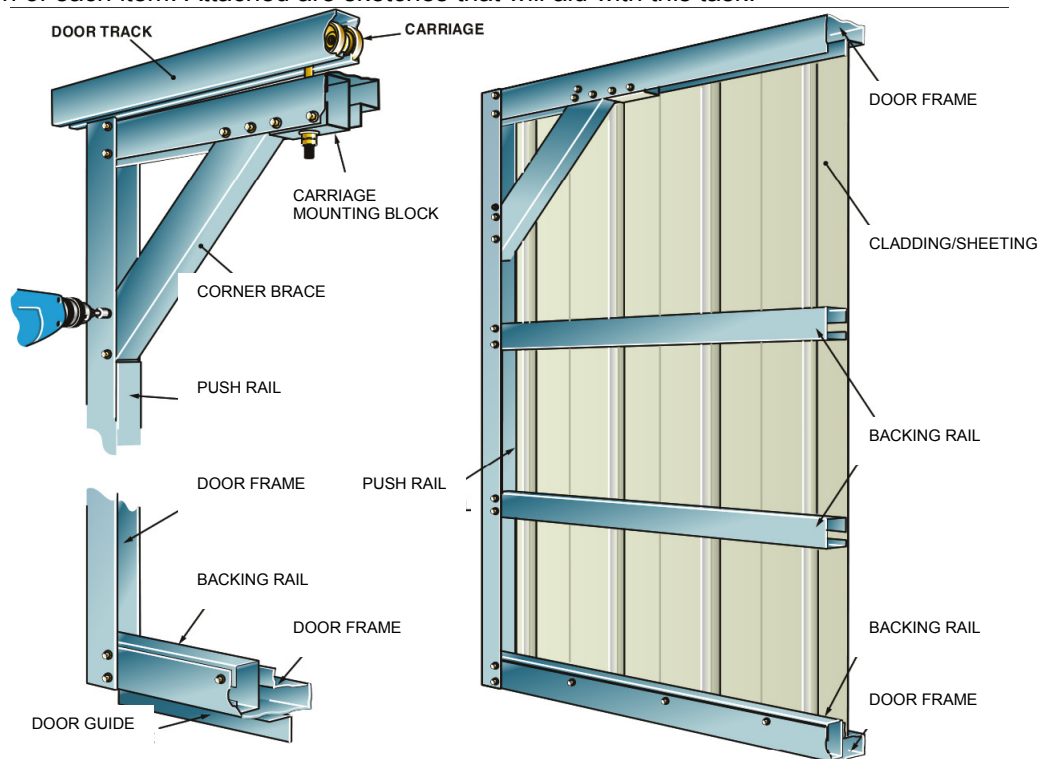

Clopay Models 835/837 Sliding Door System Installation Guide

The aim of this instruction is to guide you through the process of construction and fitting of Sliding Doors. Due to the number of sizes available this instruction is written in a generic form, but should provide sufficient details for you to complete your task successfully. In conjunction with this instruction you should refer to specification sheets and details where provided by your local distributor.

1. Ensure that you have familiarized yourself with all components, that being the description, function and application of each item. Attached are sketches that will aid with this task.



2. During the construction of the building's frame, ensure that headers or door bearers are placed to which the door track support brackets can be fitted.

3. For doors fitted to the eave side of the building this header may take the form of an additional eave purlin.

4. Where doors are to be fitted to the gable end of your building a sliding door bearer beam should be fitted web side out and connected to the flange of the side wall support columns.

5. The Sliding Door bearer beam should be supported with hangers from the roof truss, which should be fitted whilst supporting the centre of the beam to ensure it is level and straight. The hangers should be fitted no more than 10ft apart.

6. Where the entire gable end is to be opened, Outriggers can be fitted. This can be formed by fixing two columns web to web. A brace is then fitted from no more than half way down the length of the outrigger columns and the other end embedded in the outrigger brace pier. This brace should be at approximately 45 degrees to the outrigger columns. All outrigger columns and braces should be embedded in the concrete piers, and have a bracket fitted to the end that prevents the members from sliding when under load once concrete has cured.

ASSEMBLY OF DOOR FRAMES

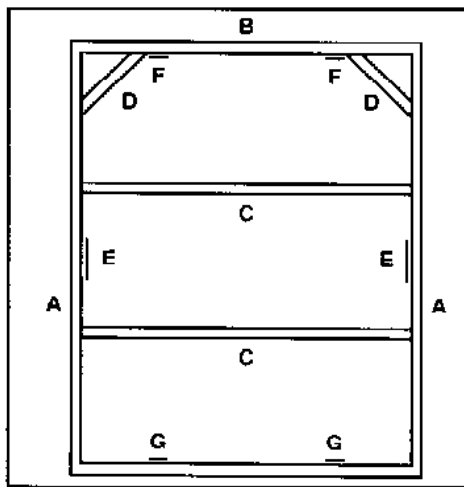

COMPONENTS

- A) Vertical Members
- B) Horizontal Top and bottom Members
- C) Support Backing Rails
- D) Angle Braces
- E) Push Rails
- F) Carriage Fixing Blocks
- G) Angle Floor Guide

7. Layout the lengths of perimeter door framing and backing rail supports ready for assembly as shown below.

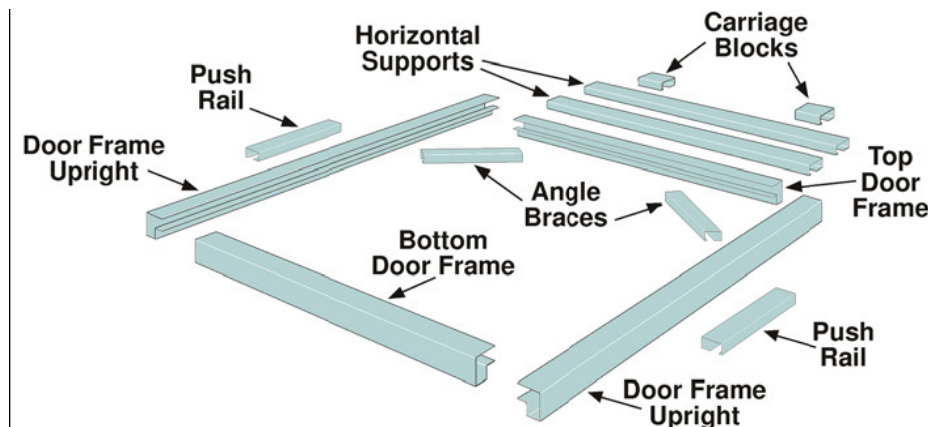

8. Position the perimeter frame sections, check height and width, and fasten with one tek screw in each corner. Square by checking diagonals, and fix with a second tek screw.

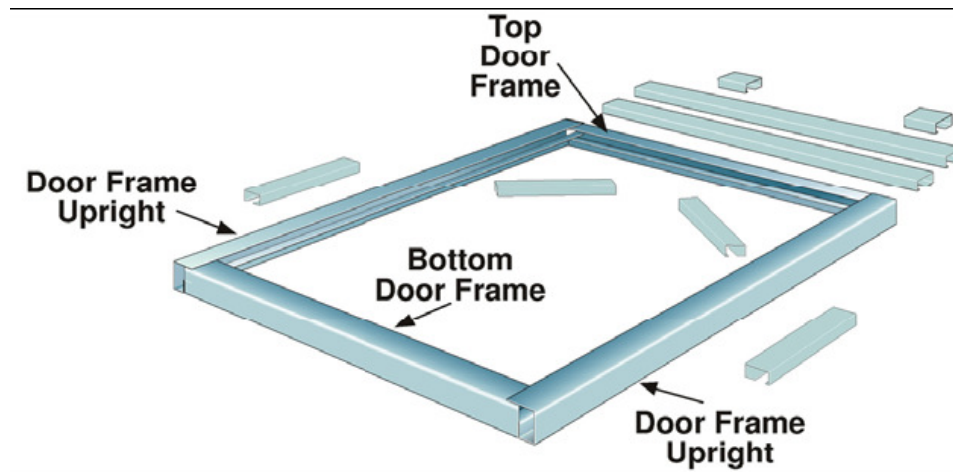

9. Position top corner angle braces, then horizontal backing rail supports. Fix with one tek screw only each end.

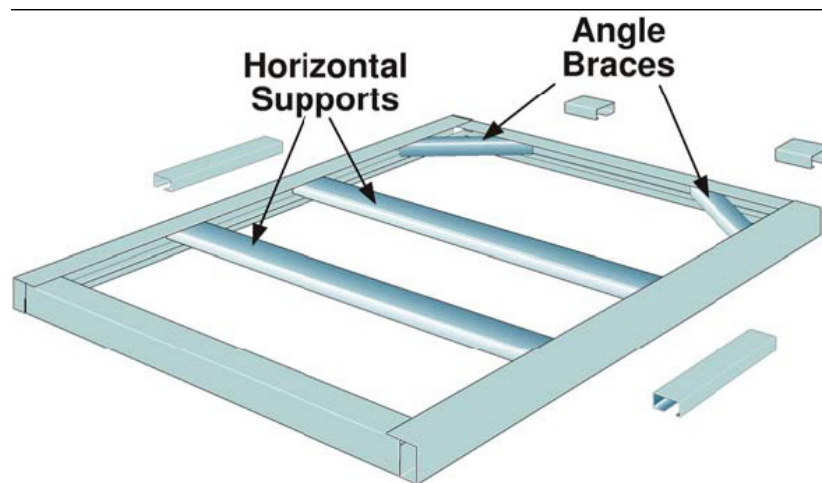

10. Position vertical push rails. Fit carriage mounting blocks.

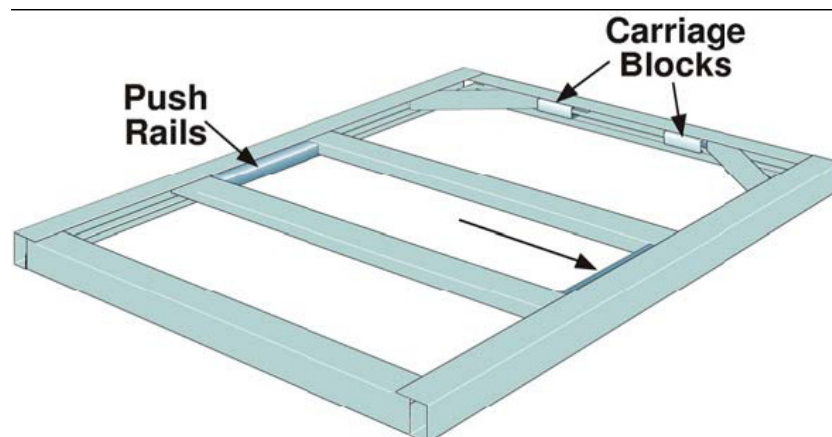

11. Finish TEK screwing frame together with 2 TEK screws per connection or joint, then drill 5/8" hole through top frame centered through carriage block for carriage pin

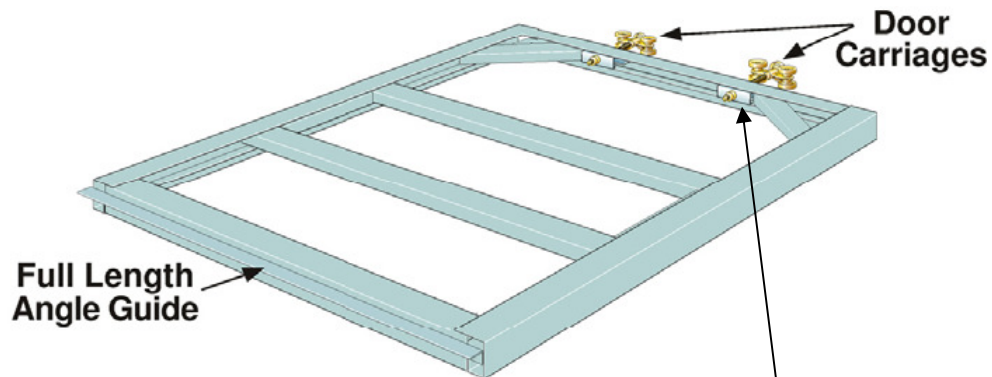

12. Fit door carriages and screw full length angle door guide to bottom of door frame.

13. Turn over and check for square again, and place a tek screw in each corner only. Fit cladding within the frame recess, tek screw to the frame and horizontal braces.

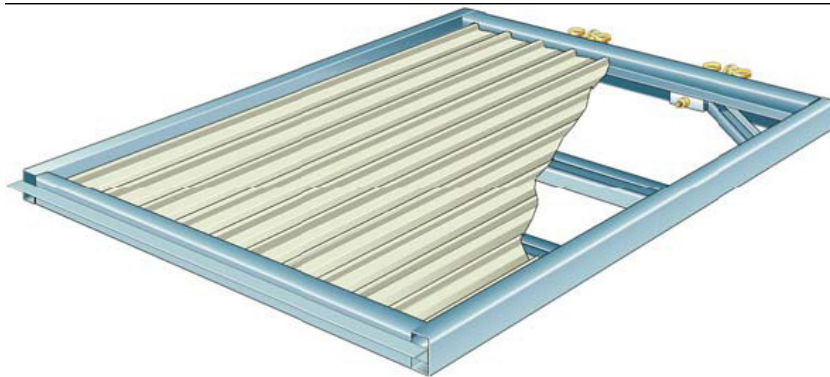

LARGE DOORS MAY BE TOO HEAVY WHEN CLADDLED AND WE WOULD RECOMMEND FITTING THE CLADDING AFTER THE DOOR FRAMES HAVE BEEN INSTALLED ON THE BUILDING.

14. As previously detailed, the sliding door header should have been fitted during the construction of the building. Cladding should be fitted to the wall (but not fastened to the header) prior to the fitting of sliding door track brackets. External gutters should normally be fitted after sliding door tracks and flashings are in place.

15. Single track systems will have a track carrying bracket welded to the track support brackets. Double track systems will have a track carrying brackets that are to be bolted on using dome headed bolts.



Single Track Bracket

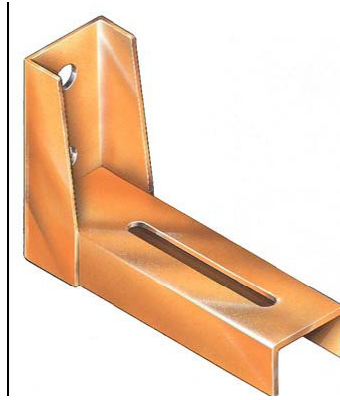

Double Support Bracket

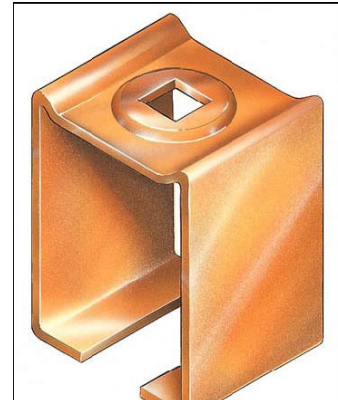

Bolt on Bracket

16. Sliding door track support brackets are then loosely fitted under the cladding into the sliding door header prior to the gutter and flashing being attached to the building. Each bracket is fitted using bolts and should not be tightened until tracks have been positioned.

17. All brackets must be evenly spaced and generally at approximately 30" centre to centre, with the first and last support brackets located approximately 2" from each end.

18. The height of the brackets can be cross-checked by working up from the floor or concrete slab. To the length of the door frame opening add 3" for top and bottom ground clearance. The result of this equation will provide a measurement equal to the distance from the footing to the underside of the assembled sliding door support bracket.

19. After all support brackets have been placed in position slide the door tracks into the support brackets and confirm their location before tightening the track support bracket bolts. Where multiple lengths of track are to be connected, track joining brackets must be used.



20. ENSURE ALL BOLTS, BRACKETS AND CONNECTORS ARE TIGHT BEFORE PROGRESSING ANY FURTHER. DOUBLE CHECK THAT ALL STEPS IN ASSEMBLING THE DOOR FRAMES HAS BEEN FOLLOWED.

21. With help, stand doors upright and move into place, you may need two people to lift the doors (one each end) and another at the top of the doors to guide the rollers into the tracks.

22. Level and height of the door frame is adjusted using the adjuster nuts on the end of the carriage, leaving the guide at the bottom of the frame $\frac{3}{8}$ " clear of the footing. Once adjusted properly ensure the lock nut is tight against the adjuster nut.

23. Floor Guide Pads are fixed to the footing or concrete floor using $\frac{5}{16}$ " sleeve anchors. A chalk line should be used to mark the line of the door guides. Floor guides are spaced evenly and that spacing should not exceed 50% of the width of the door panels. Floor guides should extend to the extremes of the door travel ensuring that a block is located at both ends and the centre of the door when it is fully opened or closed.

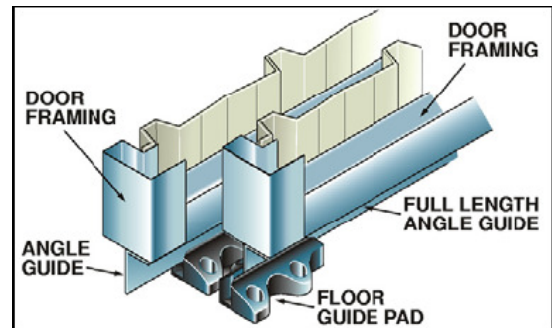
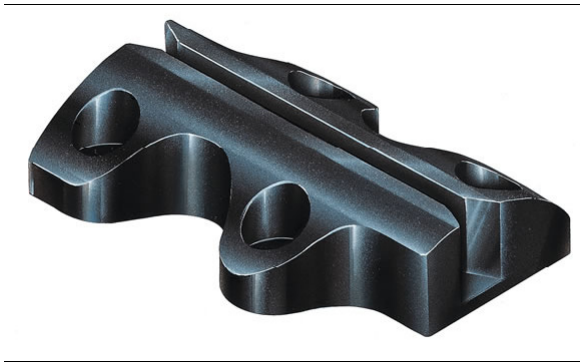

24. Where a double track system has been supplied it is advisable to fit the rear door or doors first. The track bolt on brackets may also need minor adjustment to ensure the correct clearance between doors; the rear of the front doors must be clear of the front of the rear doors by no less than $\frac{9}{16}$ ", and no greater than $1\text{-}\frac{3}{8}$ ".

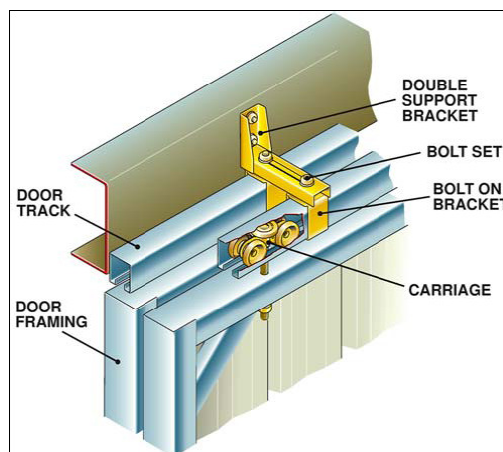

25. The over door weather flashing if used, may now be fitted over the door tracks.

26. Track stops are fitted to both ends of every track. This will stop the doors from rolling off the end of tracks.

The following illustrations indicate some 'typical' bracket installation detail for single and double tracks.

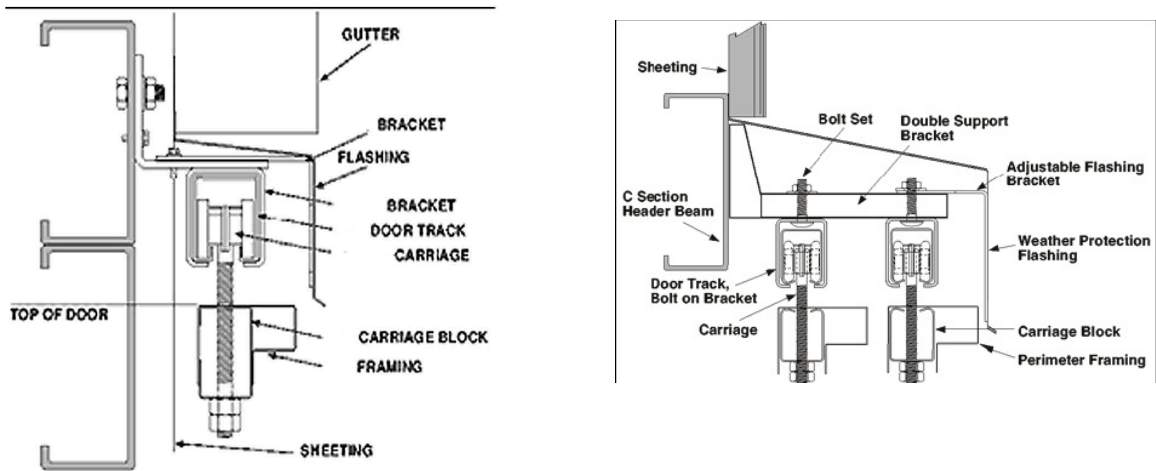

27. Test doors by pushing all frames through the full extent of travel, and make any adjustments that may be required. The action of the door should be smooth and attention should be paid to any bumps that you notice.

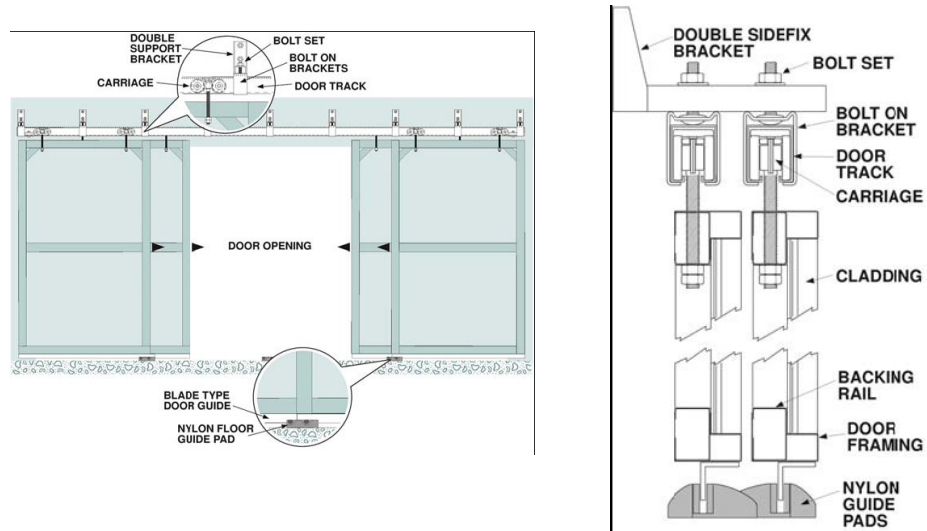

28. Cladding may now be fitted to door panels if not done during the assembly of the door frames. Again working on the rear doors first will reduce the risk of damage. Cladding may need trimming.

29. Once the cladding of doors is complete, retest the action of all doors and make any final adjustments.